

# Stratos®

HAZARDOUS AREA ASPIRATING SMOKE DETECTOR

# EX

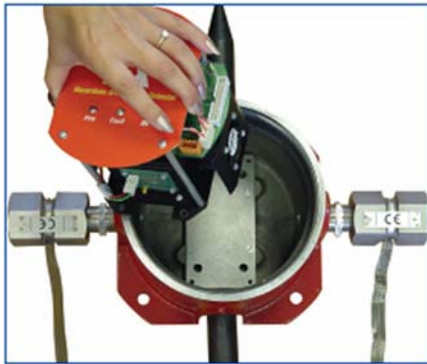

The Stratos-Ex detector internals can be removed from its enclosure for ease of installation (while area is de-classified).

## Key Features

- Lightweight design for easy one-man installation.
- Very high sensitivity provided by laser based forward light scatter for reliable incipient fire detection.
- External particles filter for ease of maintenance... no need to declassify area for routine maintenance.
- Unique ClassiFire® Perceptive Artificial Intelligence system dynamically adjusts the detector's operating parameters to allow for day to day changes in protected environment and dust filtration contamination. Consistent protection guaranteed.
- Unwanted alarms from dust are avoided using patented dual technology 3D<sup>3</sup> Laser Dust Discrimination and filtration system.
- RS485 communications built in as standard for networking and remote communications.

## Description

Stratos-Ex is designed to provide reliable very high sensitivity smoke detection for hazardous areas in a small package.

ClassiFire Perceptive Artificial Intelligence ensures that the detector operates at optimum sensitivity for the protected environment without the need for complicated setup. This means the detector will configure itself to provide and maintain high sensitivity in a clean room or reduced sensitivity in areas with a high ambient background.

The detector is supplied in a cast aluminum enclosure. All sampling pipes and cables can be connected to the enclosure as a first fix operation, leaving the internals to be fitted during the final commissioning phase.

Upgradeable volt-free Fire and Fault relay outputs are available for remote monitoring by local fire detection or BMS systems.

## Applications & Acceptance

Stratos detectors have been successfully applied in tens of thousands of applications worldwide, ranging from Clean Rooms to Casinos.

## Options Available

- Addressable Protocol Interface Cards APIC™ available for most popular industry signaling protocols.
- Command Module available for central monitoring, display and set-up.
- SenseNET compatible - up to 127 detectors per network loop.
- Remote Display units available (not suitable for installation within hazardous environment).

## Approvals

- ATEX rated d IIB + H<sup>2</sup> T3. Equipment group 2 (zones 1, 2 and 3). Group gases A and B + Hydrogen.

## Stratos-Ex Dimensions

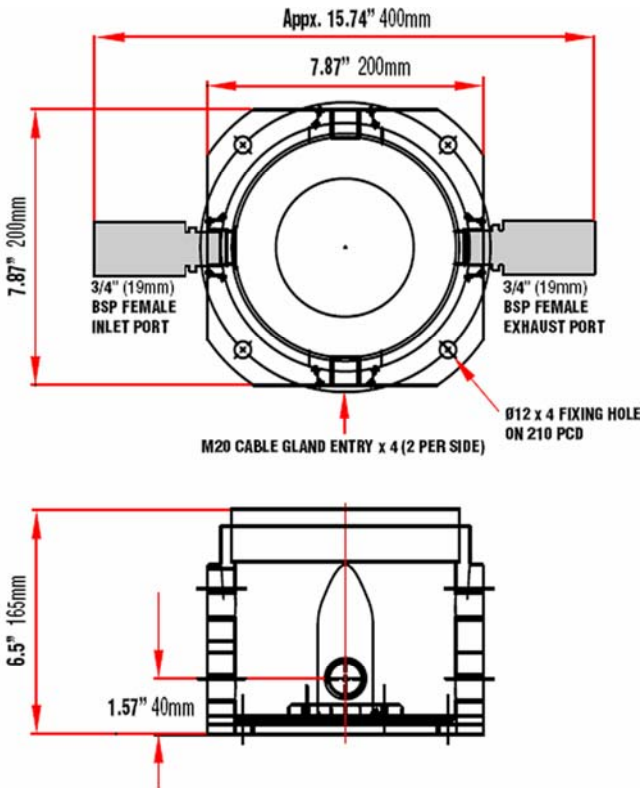

## Filter Replacement

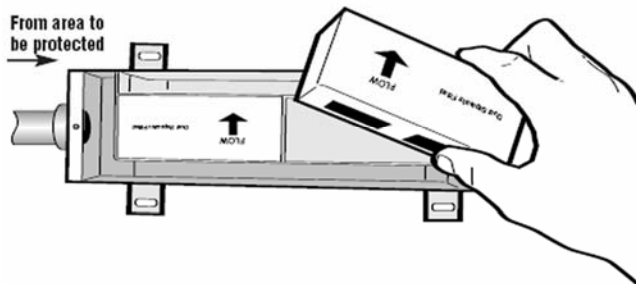

## ORDERING INFORMATION

Part No.	Description
30731	Stratos-Ex Detector
30732	Stratos-Ex Detector (stainless steel Version)
30072	Replacement External Filter Cartridge
30730	External Filter Assembly
30240	Setup and Servicing Software (free of charge)
30419	Null Model RS232 Serial Cable (pc interface)
30804	SenseNET RS485/RS232 PC Interface
30436	Relay Input Card
30902US	24VDC 2.5 amp Regulated Power Supply

## SPECIFICATIONS Stratos-Ex

Supply Voltage	21.6 – 26.4V DC
Current Consumption	1.1A @ 24V DC
Size (excluding cable glands)	15.7w x 7.8h x 6.49d (inch) 400w x 200h x 165d (mm) including flame arrestors
Weight	18.7lb (8.5kg)
Enclosure Material	Aluminum Alloy
Operating Temperature Range	14 to 140° F (-10 to 60° C)
Operating Humidity Range	0 – 90% RH non-condensing
Measurement Range	0.00046% to 7.62% obs/ft (0.0015% to 25% obs/m)
Maximum Display Resolution	0.00046% obs/ft (0.0015% obs/m)
Status LEDs	Fire, Fault, OK
Detection Principle	Laser light scattering mass detection and particle evaluation
Particle Sensitivity Range	0.003µ to 10µ
Dust Discrimination Principle	3D <sup>3</sup> Laser Dust Discrimination (LDD)
Recommended max. Pipe Length	164ft (50m)
Sampling Pipe Diameter	¾" (19mm) Nominal bore, 1" (27mm) OD
Recommended maximum number of sampling ports	10
Alarm Levels	4 (Aux, Pre-Alarm, Fire 1 and Fire 2)
Laser Lifetime (MTTF)	Greater than 1000 years
Programming	Command Module or PC via RS232/RS485
Network Data Bus	RS485
Maximum total Data Bus Length	4000ft (1200m)
IP Rating	IP65
Sampling Pipe Inlets	1
Exhaust Air Pipe Outlets	1
Cable Entries	4 x M20
Details (Threads)	¾" (19mm) BSP female inlet and exhaust

## APPLICATIONS

- **Oil Platforms**
- **Critical Equipment**
- **Pharmaceutical Areas**
- **Marine Environments**
- **Plant Rooms**
- **Motor Rooms**
- **Equipment Racks**
- **LNG Plants**
- **Production Areas**
- **Battery Rooms**
- **Hazardous Areas**
- **Petrochemical**

